



## 31 COCHRAN STREET, PAISLEY. PA1 1JY.

THIS SELDOM AVAILABLE ONE BEDROOM FIRST FLOOR FLAT SITS ON COCHRAN STREET WITH AN OPEN OUTLOOK OVER THE BOWLING GREEN AND PARK, WITH STUNNING VIEWS OVER THE OLD ANCHOR MILLS AND GLENIFFER BRAES. THE FLAT ITSELF IS IN GOOD ORDER INTERNALLY, AND BENEFITS FROM GAS CENTRAL HEATING AND DOUBLE GLAZING. SECURITY DOOR ENTRY SYSTEM ACCESSES THE COMMUNAL CLOSE, AND COMMUNAL GROUNDS TO THE REAR PROVIDE A DRYING GREEN. AMPLE ON STREET PARKING. IDEAL FIRST TIME PURCHASE OR BUY TO LET INVESTMENT.



- ONE BEDROOM FLAT
- GAS CENTRAL HEATING
- DOUBLE GLAZING
- CLOSE TO LOCAL AMENITIES
- SOUGHT AFTER LOCALE
- SECURE DOOR ENTRY
- STUNNING VIEWS TO FRONT
- TENURE - ABSOLUTE OWNERSHIP

**OFFERS OVER £70,000**

**31 COCHRAN STREET,  
PAISLEY. PA1 1JY.**

**OFFERS OVER £70,000**

**ENTRANCE HALLWAY 9' 8" x 7' 2" (2.94M x 2.18M)**

ENTRANCE HALLWAY GIVES ACCESS TO ALL ROOMS IN THE PROPERTY. LARGE SHELVED STORAGE CUPBOARD (1.91 x 0.98) FRESH DECOR THROUGHOUT. GREY WOOD EFFECT LAMINATE FLOORING.

**LOUNGE 13' 1" x 10' 11" (3.98M x 3.34M)**

GOOD SIZED LOUNGE GIVING SPECTACULAR VIEWS OVER THE OLD ANCHOR MILLS ONTO THE GLENIFFER BRAES, ALSO THE LOCAL BOWLING GREEN AND PARK. GREY WOOD EFFECT LAMINATE FLOORING.

**KITCHEN 12' 4" x 5' 3" (3.75M x 1.60M)**

KITCHEN HAS WHITE WALL AND BASE STORAGE UNITS, WHITE TILE SPLASH BACK AND GREY MARBLE EFFECT WORK SURFACE. NECHT 5 RING GAS BURNER WITH GREY MARBLE SPLASH BACK, AND BRAND NEW ELECTRIC FAN OVEN. WASHING MACHINE. GREY TILE EFFECT LAMINATE FLOORING. 3 WAY CEILING SPOTLIGHT. WINDOW TO REAR.

**BEDROOM 12' 4" x 9' 10" (3.76M x 3.0M)**

DOUBLE BEDROOM HAS AMPLE STORAGE SPACE. FRESH DECOR. GREY WOOD EFFECT LAMINATE FLOORING. VIEWS OVER THE REAR OF THE PROPERTY.

**BATHROOM 6' 6" x 5' 6" (1.99M x 1.68M)**

THREE PIECE SUITE WITH OVERHEAD ELECTRIC SHOWER UNIT. SHOWER CURTAIN AND RAIL. DECORATIVE WALL TILING SURROUNDING BATH AND SHOWER AREA. LIGHT GREY TILE EFFECT LAMINATE FLOORING.

**COMMUNAL REAR GARDEN**

COMMUNAL REAR GARDEN AND DRYING AREA.



FIRST FLOOR

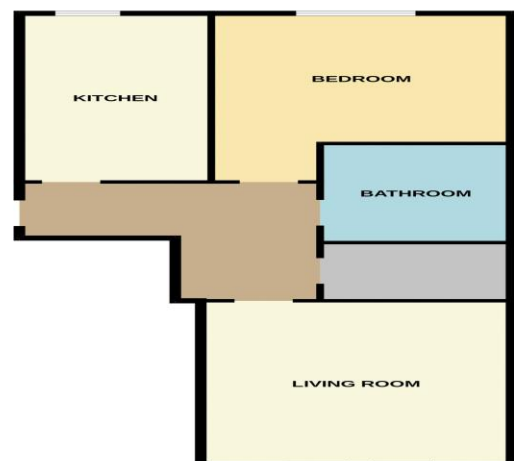

Whilst every attempt has been made to ensure the accuracy of the floorplan contained here, measurements of rooms, corridors, stairs and other areas, are approximate and the responsibility to check the accuracy of any measurement, falls upon the purchaser. This plan is for illustrative purposes only and should be used as a guide only. Measurements are taken to the furthest extent possible and are not intended to be used for any other purpose. The purchaser should refer to the actual floor plan for further details and for any other information. Make sure you check the floor plan for any other information. ©2024

As a regulated business we are required to comply with the "The Money Laundering, Terrorist Financing and Transfer Funds (Information on the Payer) Regulations 2017. Intending purchasers will be asked to produce documentation to satisfy these requirements on acceptance of a formal offer. These will include proof of identification, proof of address and proof of funds to facilitate the purchase including deposit and any loan funds. Your cooperation in this is greatly appreciated.

DISCLAIMER - WHILST WE ENDEAVOR TO MAKE THESE PARTICULARS AS ACCURATE AS POSSIBLE, THEY DO NOT FORM PART OF ANY CONTRACT OR OFFER, NOR ARE THEY GUARANTEED. MEASUREMENTS ARE APPROXIMATE AND IN MOST CASES ARE TAKEN WITH A DIGITAL/SONIC MEASURING DEVICE AND ARE TAKEN AT THE WIDEST POINT. WE HAVE NOT TESTED THE ELECTRICITY, GAS OR WATER SERVICES OR ANY APPLIANCES. PHOTOGRAPHS ARE REPRODUCED FOR GENERAL INFORMATION AND IT MUST NOT BE INFERRED THAT ANY ITEM IS INCLUDED FOR SALE WITH THE PROPERTY. IF THERE IS ANY PART OF THIS THAT YOU FIND MISLEADING OR SIMPLY WISH CLARIFICATION ON ANY POINT, PLEASE CONTACT OUR OFFICE IMMEDIATELY WHEN WE WILL ENDEAVOR TO ASSIST YOU IN ANY WAY POSSIBLE.



**OFFERS OVER £70,000**